

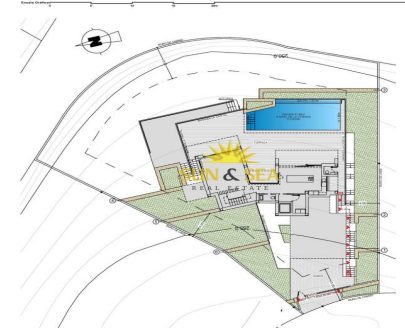

Réf.

**Consulter**





## Principales caractéristiques

■ Énergie: En cours

## Les caractéristiques

■ Air Conditioning: Pre-Installed

■ Double Bedrooms: 3

■ Gated

■ Location: Coastal, Urbanisation

■ Near Schools

■ Piscine privée

■ Under-Build / Basement

■ Views: Sea

■ Beach: 1000 Meters

■ Elevator/Lift

■ Jardin

■ Near Commercial Center

■ Number of Parking Spaces: 2

■ Terrace: 299 Msq.

■ Useable Build Space: 177 Msq.